

Tristram's
Sales and Lettings



Tristram's
Sales and Lettings

Hartley Road
Radford, Nottingham, NG7 3BB

- Students 2021/2022
- Bills not included.
- Allocated Parking Space
- Great location for amenities.

£250 pw
EPC Rating '78'



Tristram's
Sales and Lettings



Tristram's
Sales and Lettings



Property Description

BRIEF

STUDENTS 2021/2022. A fantastic student flat located between Nottingham City and University of Nottingham. Full furnished two bedroom flat with modern open plan living/kitchen area. The flat also benefits from a secure allocated parking space and intercom entry system. Call to view.

KITCHEN/LIVING AREA

A modern open plan kitchen and living room consisting of modern fitted kitchen with appliances, sofa and dining table with chairs. Large windows and very high ceilings.

BEDROOM 1

Spacious double bedroom with large window, high ceilings and furniture.

BEDROOM 2

Entry from the hallway, double bedroom with large windows and high ceilings.



BATHROOM

Fitted bathroom suite consisting of Wc, Sink and Bath with overhead shower.

EXTERNAL

Allocated off-street parking. Access to the flat is via two gated communal entrances with intercom system.

THE AREA

The area of Lenton attracts students from ALL campuses at the University of Nottingham AND Nottingham Trent University.

Known to many as 'The Lenton Triangle', many are attracted to this area due to it's great transports links. Lenton has a direct road through it called Derby Road, where there are frequent buses in and out of the Centre and to all Campuses and hospitals. There is a local Sainsburys based on Derby Road which is a common pitstop for students grabbing their essentials.

For further shopping there is Caslte Park consisting of your favourtie discount stores such as Poundland, B&M Bargains and Wilkos. Not to mention, Castle Marina Retail Park which hosts a Pure gym, Sainsburys Superstore, Costa, Pizza Hut and Mcdonalds (along with countless others).

Don't miss out! Call or email to enquire today and we can help!

First Floor

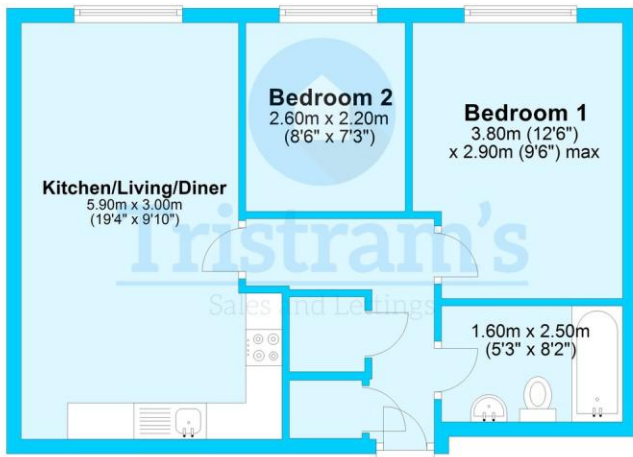

Score	Energy rating	Current	Potential
92+	A		
81-91	B		81 B
69-80	C	78 c	
55-68	D		
39-54	E		
21-38	F		
1-20	G		

260 -262 Derby Road
 Bramcote
 Nottingham
 NG9 3JN

www.tristrams.uk.com

Agents Note: Whilst every care has been taken to prepare these sales particulars, they are for guidance purposes only. All measurements are approximate and are for general guidance purposes only and whilst every care has been taken to ensure their accuracy, they should not be relied upon and potential buyers are advised to recheck the measurements.